

# ECOS CONTEMPO SIZE & PRICE GUIDE

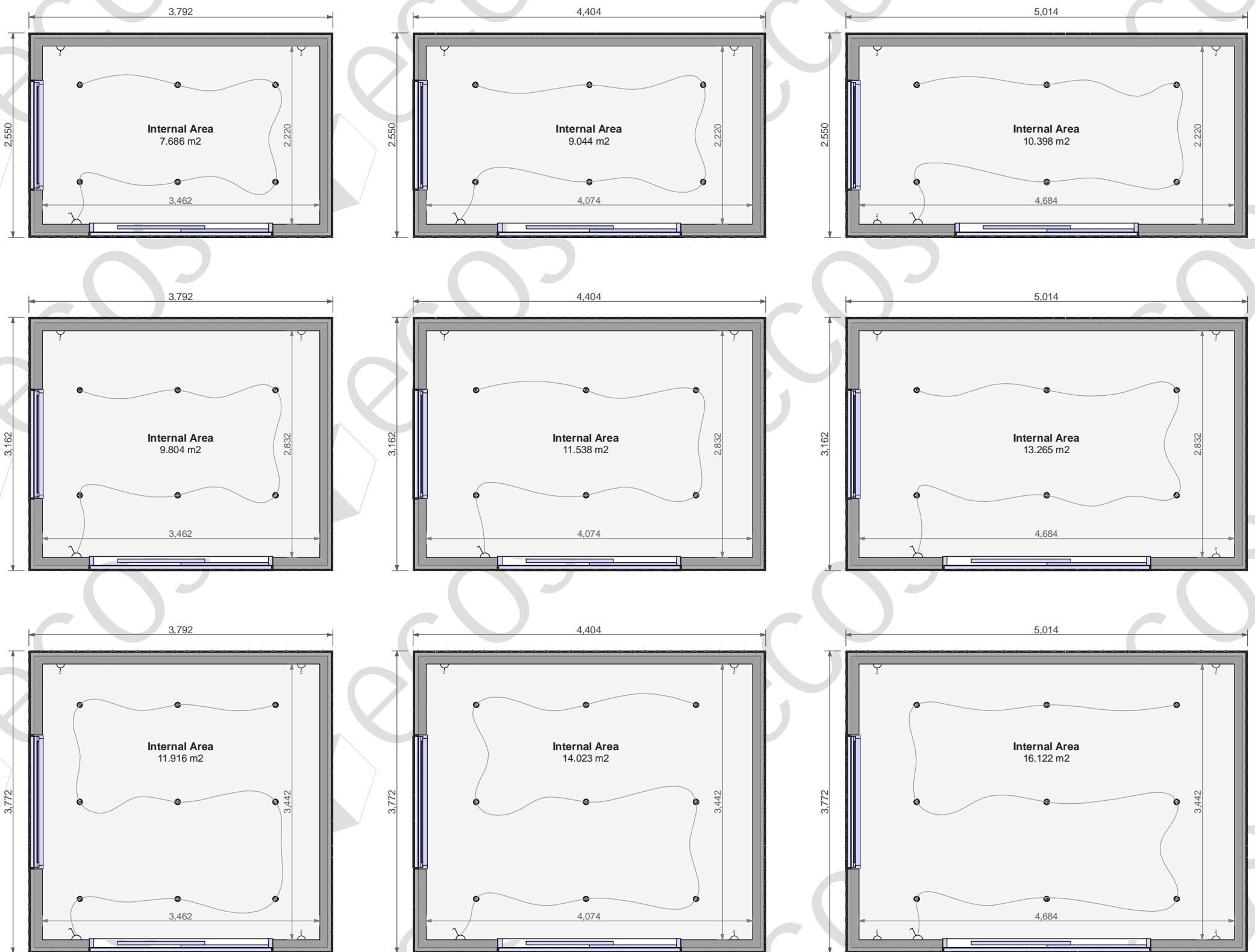

## ECOLOGIC

- **REINFORCED STEEL BEAM FOUNDATION**  
Designed to provide solid, life time support to garden office.
- **COSY SEMI SOLID OAK FLOORING**  
This flooring combines a premium wood finish with functional advantages and affords warmth and elegance in the office.
- **BEAUTIFUL WESTERN RED CEDAR CLADDED WALLS**  
Western red cedar is one of the world's most durable woods. It is naturally resistant to moisture, decay and insect damage. cedar cladded walls of the office will last for decades, even in harsh environments while exposed to sun, rain, heat and cold all year round.
- **SOLID TIMBER WINDOW AND SLIDING DOOR**  
An environmentally sound and sustainable, only solid timber windows and doors can offer uncompromised beauty and bring warmth and harmony into your office. The sliding door saves space and can be opened to give a clear unobstructed opening.
- **PLASTERED AND PAINTED INTERIOR**  
Painted smooth skim coat over foil back plasterboard.
- **SOLID FIBERGLAS ROOF**  
Hard wearing and virtually indestructible, totally waterproof and maintenance free, comes with lifetime warranty.
- **PVC GUTTER AND DOWNPIPE**  
Black, durable and practical PVC gutter and downpipe.
- **ELECTRICAL - LIGHTS AND POWER POINTS**  
As standard comes with two double sockets, six energy saving LED down lights and double switch, external strip LED light is optional.
- **HEATING - ELECTRIC HEATER**  
A choice of oil filled or convector heaters, which is enough to keep your office warm in the winter.
- **INSULATED IN COMPLIANCE WITH REGULATIONS**  
Modern, highly effective insulation materials together with unique design employed to achieve energy efficiency of the office to comply with Irish Building Regulations. Optionally airtight.

## ECONOMIC

- **STEEL BEAM FOUNDATION**  
Designed to provide solid support to garden office.
- **PRACTICAL LAMINATED OAK FLOORING**  
This flooring extremely durable and attractive, it is scratch and stain resistant and ideal for areas with a high degree of foot traffic, especially by children and pets. This type of flooring is very easy to maintain and does not fade even in direct sunlight.
- **BEAUTIFUL WESTERN RED CEDAR CLADDED WALLS**  
Western red cedar is one of the world's most durable woods. It is naturally resistant to moisture, decay and insect damage. cedar cladded walls of the office will last for decades, even in harsh environments while exposed to sun, rain, heat and cold all year round.
- **PVC WINDOW AND DOUBLE DOOR**  
Incorporating advanced design and materials sliding door allows you to enjoy the sunshine and garden outside your office without compromising the warmth and security.
- **PLASTERED AND PAINTED INTERIOR**  
Painted smooth skim coat over foil back plasterboard.
- **FIRESTONE EDPM ROOF**  
Eco friendly, durable, with 50 years life expectancy, firestone EDPM membrane is fully adhered directly to the substrate using firestone bonding adhesive.
- **PVC GUTTER AND DOWNPIPE**  
Black, durable and practical PVC gutter and downpipe.
- **ELECTRICAL - LIGHTS AND POWER POINTS**  
As standard comes with two double sockets, six energy saving LED down lights and double switch, external strip LED light is optional.
- **HEATING - ELECTRIC HEATER**  
A choice of oil filled or convector heaters, which is enough to keep your office warm in the winter.
- **WELL INSULATED**  
Various glass wool insulation used to insulate floor, walls and roof.

PRICE INCLUDES DELIVERY WITHIN ROI, INSTALLATION BY PROFESSIONAL CRAFTSMEN AND ELECTRICAL CONNECTION.

ECOS,  
UNIT 8 THE ELMS,  
OAKTREE BUSINESS PARK,  
TRIM, CO. MEATH,  
IRELAND

M: 087 3108584  
info@ecospace.ie  
www.ecospace.ie